

**QHi** Rail

# LUBRICATORS CATALOGUE



**QHi-Rail**  
Tel. 01582 461123  
[www.qhigroup.com](http://www.qhigroup.com)



**RAIL LUBRICATORS  
LUBRICANTS  
SERVICE  
TRAINING  
INSTALLATION  
FRICTION MODIFICATION  
REMOTE MONITORING**

# CONTENTS

QHi Rail are committed to working with the rail industry to develop the best in UK manufactured mechanical and electric rail lubricators.

**PAGE 1**  
**CONTENTS**

**PAGE 9-13**  
**MECHANICAL RAIL  
LUBRICATORS**

**PAGE 16**  
**EASICHECK  
(CHECK BLADE)**

**PAGE 19**  
**NULUBE  
POINTS LUBRICANTS**

**PAGE 2-6**  
**ELECTRIC RAIL  
LUBRICATORS**

**PAGE 14**  
**LUBRICURVE EASIPUMP**

**PAGE 17**  
**LUBRICURVE  
FRICTION EASE**

**PAGE 20**  
**INDEX**

**PAGE 7-8**  
**MEMOLUB (CANISTER  
LUBRICATOR)**

**PAGE 15**  
**EASIBLADE  
(PIVOTING BLADE)**

**PAGE 18**  
**WHITMORE  
BIO-DEGRADABLE GREASE**



# LUBRICURVE ELECTRO 10, 20, 30

## QHi ELECTRIC RAIL LUBRICATORS SINGLE ROAD & DUAL ROAD



The Lubricurve Electro 10 & 20 electric rail lubricators provide the next step up from mechanical and hydraulic lubricators with high and low rail blades for multi-curve rail lubrication. Ideal for reverse curves, one unit can replace up to eight conventional lubricators.

The robust (80cm x 50cm) cabinet houses the main components of the lubricator protecting them from the elements and vandalism.

With systems pumping from 8 metres to 30 metres the cabinet can be sited in a place of safety for easy maintenance and filling. This makes them suitable for red zone prohibited areas and station throats.

A twin chamber pump with direct gravity feed from the reservoir means there is no residual bio-degradable grease left in the reservoir which can potentially block the system. The grease is pumped to blades via twin output hoses which allows blade staggering on left and right rails for optimum grease pickup.

Precise grease output is dictated by stepped control box settings and is independent of grease viscosity, this helps to keep the ballast and bottom of trains clean.

Short blades give greater lubricator position flexibility and can be installed in curves to ensure best grease pick up.

There are also options for single or twin road applications.

T: 0044 (0) 1582 461123

www.qhigroup.com

e-mail: sales@qhigroup.com



**GREASE CARRY UP TO  
8 KM THROUGH 8  
REVERSES**

**PUMPING INITIATED BY A  
NON CONTACT SENSOR  
FOR AXLE COUNTING**

**MAST MOUNTED SOLAR  
AND WIND POWER,  
OPTIONAL CABINET  
MOUNTED SOLAR POWER,  
MAINS POWER OR A  
COMBINATION**

**SIMPLE, FAST  
INSTALLATION – 2 HOURS**

**TWIN SLEEPER  
INSTALLATION**

**ROBUST TRACKSIDE  
CABINET WITH THREE  
POINT LOCKING SYSTEM  
FOR FULL HEIGHT  
SECURITY DOOR – NO  
PADLOCKS**

**STORAGE FOR UP TO 4  
SPARE TUBS OF GREASE**

**VARIOUS EASIBLADE  
OPTIONS INCLUDING FULL  
CIRCUMFERENCE BLADE  
COVER FOR ALL RAIL  
TYPES**

**FILLING HATCH FOR EASY  
FILL STRAIGHT FROM TUB**

**BASE MODEL 75KG  
RESERVOIR WITH 200KG  
AND 360KG OPTIONS**

**EASILY MAINTAINED – ALL  
BLADES STRIPPED AND  
CLEANED IN 40 MINUTES**

**POWER SOURCE CAN BE  
MOUNTED UP TO 100M  
FROM THE CABINET**

**REMOTE MONITORING AS  
AN OPTION**

# Schematic of Solar & Wind Powered Electro 10 Electric Rail Lubricator (ex blades, hoses & fittings)

LCS103-12

**LCS205-02**  
Wind Generator

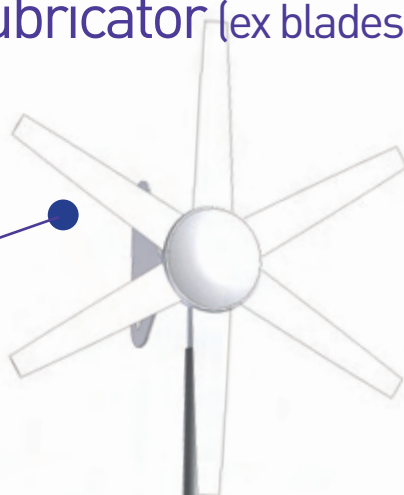

**LCS205-16**  
Graffiti/Vandalism Cover

**LCS205-01**  
30W Solar Panel

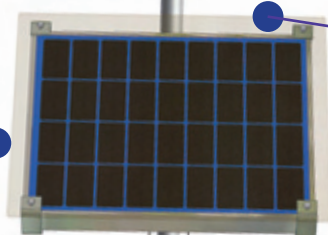

**LCS205-51**  
Cabinet Hinged Lid

**LCS105-12**  
Upper 1.1m Mast Section

**LCS205-34**  
Cabinet Filling Lid Lock Plate

**LCS205-27**  
Mast and Fittings

**LCS205-43**  
Control Panel Fascia with Back Light

**LCS205-03**  
Battery charger  
Solar/Wind

**LCS205-04**  
Pump control unit

**LCS205-39**  
Cabinet door & locks

**LCS205-11**  
Battery assembly

**LCS205-05**  
Gear pump

**LCS205-36**  
Cabinet

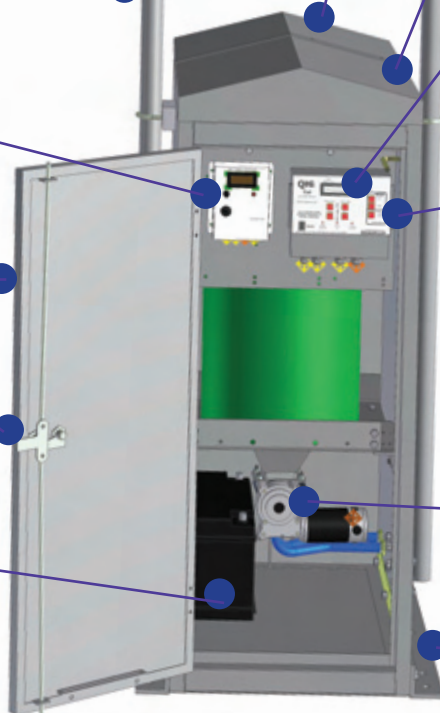

# Schematic of Solar Powered Electro 10 Electric Rail Lubricator (ex blades, hoses & fittings) LCS103-11

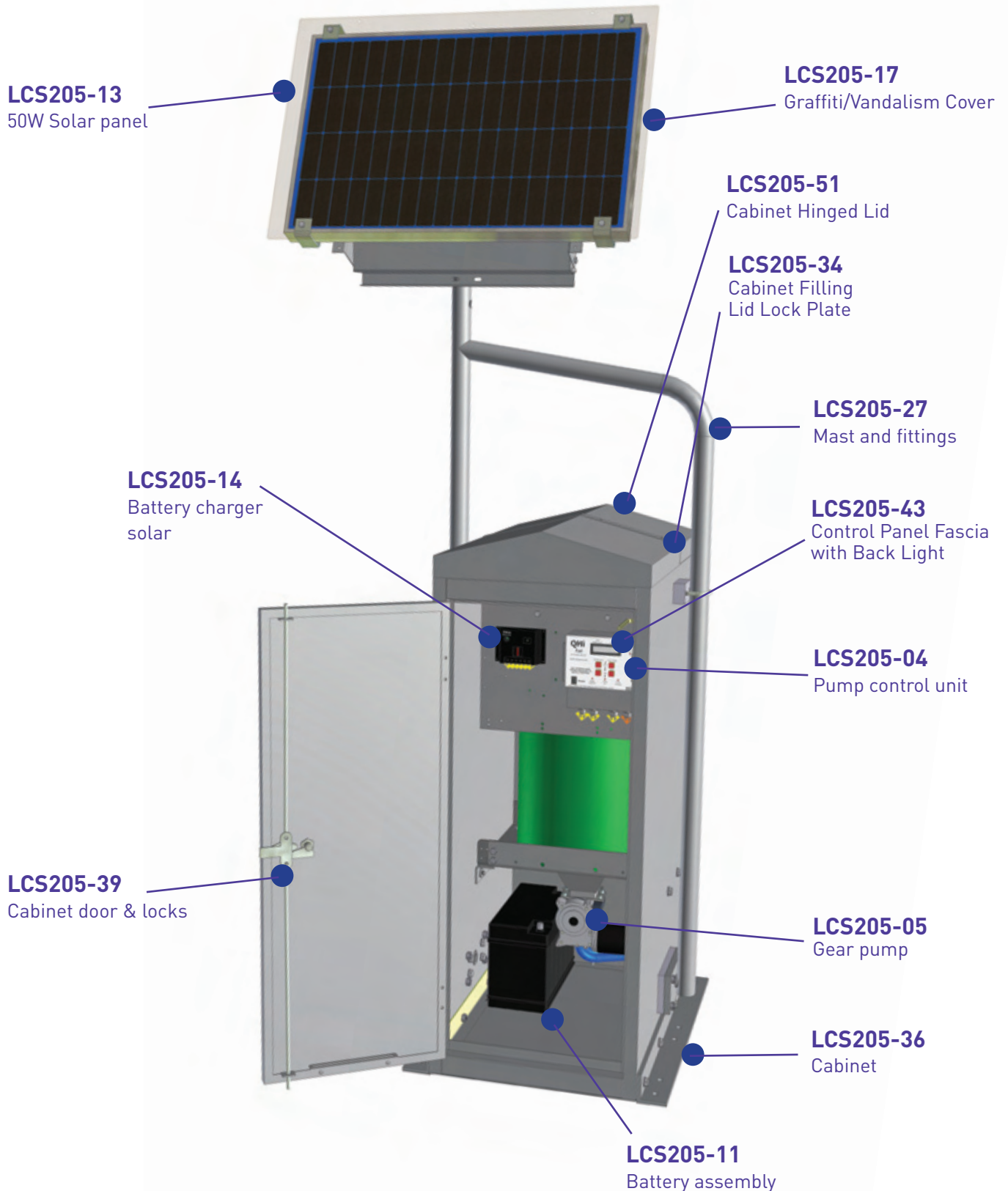

# Schematic of Mains Powered Electro 10 Electric Rail Lubricator (ex blades, hoses & fittings) LCS103-13



T: 0044 (0) 1582 461123

www.qhigroup.com

e-mail: sales@qhigroup.com

# QHi MEMOLUB

## ELECTRIC CANISTER BASED LUBRICATOR

The Memolub canister rail lubricator is a positive displacement unit driven by batteries.

It operates consistently, irrespective of ambient temperature to give best lubrication on point tips, short sections of check rail and even on full curves where multiple units can be deployed.

Simple cartridge replacement without full unit disposal saves money and resources.



**RE-USABLE NOT  
DISPOSABLE – REDUCE  
WASTE, SAVES  
ENVIRONMENT**

**COST EFFECTIVE**

**EASY TO INSTALL**

**FITS ANY MAKE OF GDU**

**SUITABLE FOR:**

- A) RUNNING RAILS**
- B) CHECK RAILS**
- C) POINT ENDS**
- D) ALL RAIL PROFILES**

**PROGRAMMABLE RANGE  
OF GREASE OUTPUT  
SETTINGS**

**CONSISTENT OPERATION  
OVER WIDE  
TEMPERATURE RANGE**



# Schematic of Memolub (canister) Rail Lubricator on Easi-blade

LCS300-58  
Full system for UIC54, UIC60, BV50 rails

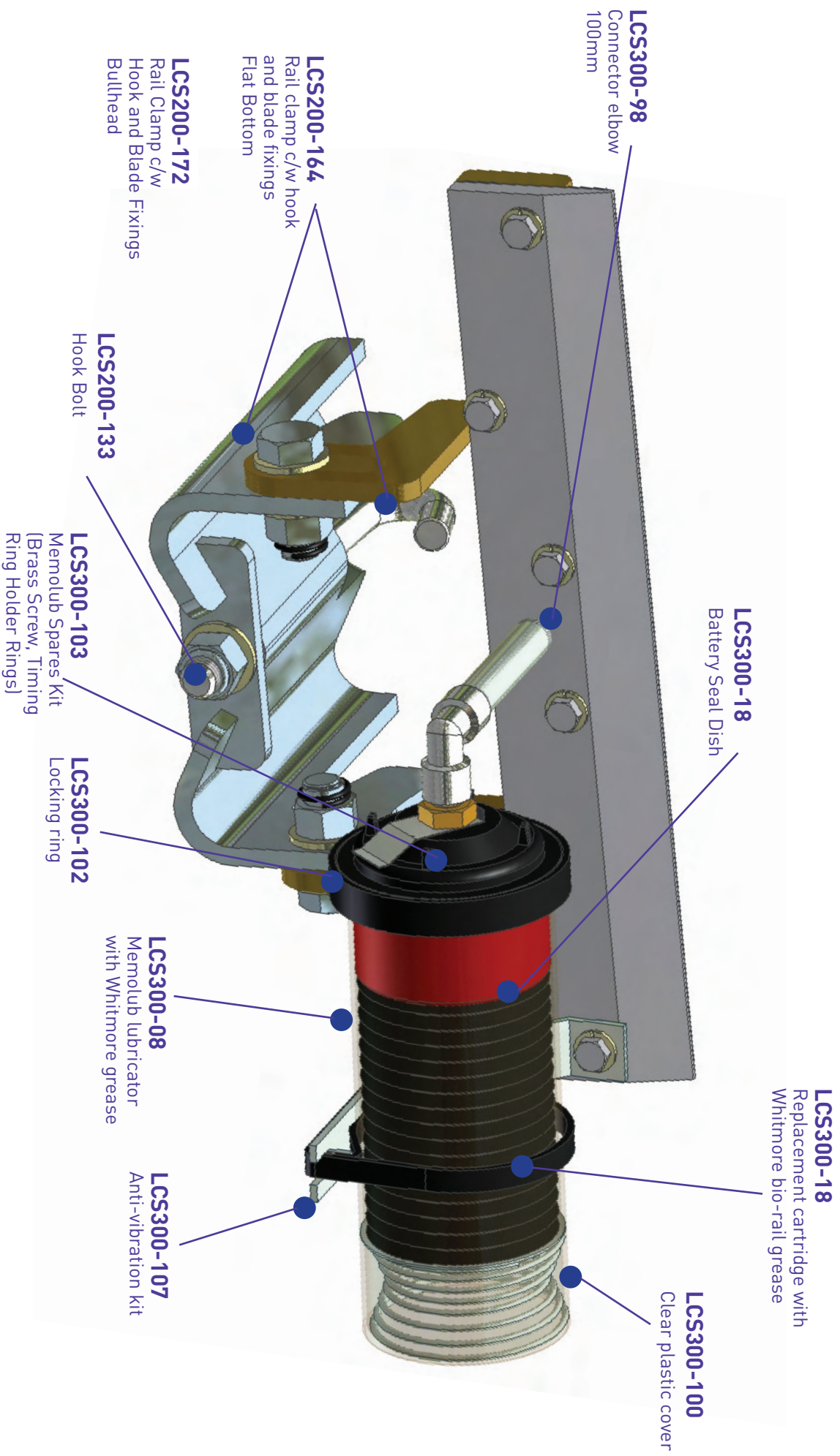

T: 0044 (0) 1582 461123

www.qhigroup.com

e-mail: sales@qhigroup.com

# LUBRICURVE PD50

## QHi MECHANICAL RAIL LUBRICATOR

The QHi Lubricurve PD50 is a simple, efficient lubricator giving high performance with low maintenance. Easy to install and suiting all types of rail profile, QHi rail lubricators can now be found all over the world.

A patented positive displacement pump dispenses a consistent grease volume suitable for high or low speed traffic with minimal plunger movement. The latter ensures reduced wear to plungers and hence less maintenance.

Grease output is not speed dependent and can be set up for low output, a factor often essential for light rail and tramway lubrication.

Distribution blades offer various size options and the modular design enables easy installation and replacement with minimal blocking. There is simple blade height adjustment for precise delivery of grease to wheel flange and optional blade troughs to collect excess grease for easy cleaning. Blades can be fitted for high rail lubrication, check rail lubrication or both rails for reverse curve lubrication from one unit.

Reservoirs are robust, durable, lightweight aluminium and designed for quick fill with 35kg and 70kg options.

New products include low clearance reservoirs and clamps for use with slab track.

**HIGH PERFORMANCE**

**EASY TO INSTALL**

**LOW MAINTENANCE**

**SUITS ALL RAIL TYPES**

**COMPATIBLE WITH  
OTHER MECHANICAL  
AND HYDRAULIC  
SYSTEMS**

**POSITIVE DISPLACEMENT  
PUMP (STANDARD & LOW  
OUTPUT OPTIONS)**

**MODULAR BLADE DESIGN  
VARIABLE BLADE SIZE**

**STANDARD & EASI BLADE  
OPTIONS**

**BLADE TROUGH**

**ROBUST LIGHTWEIGHT  
RESEVOIR 35 OR 70 KG  
CAPACITY**



# Schematic of Typical Pump for LubriCurve PD50 Mechanical Rail Lubricator

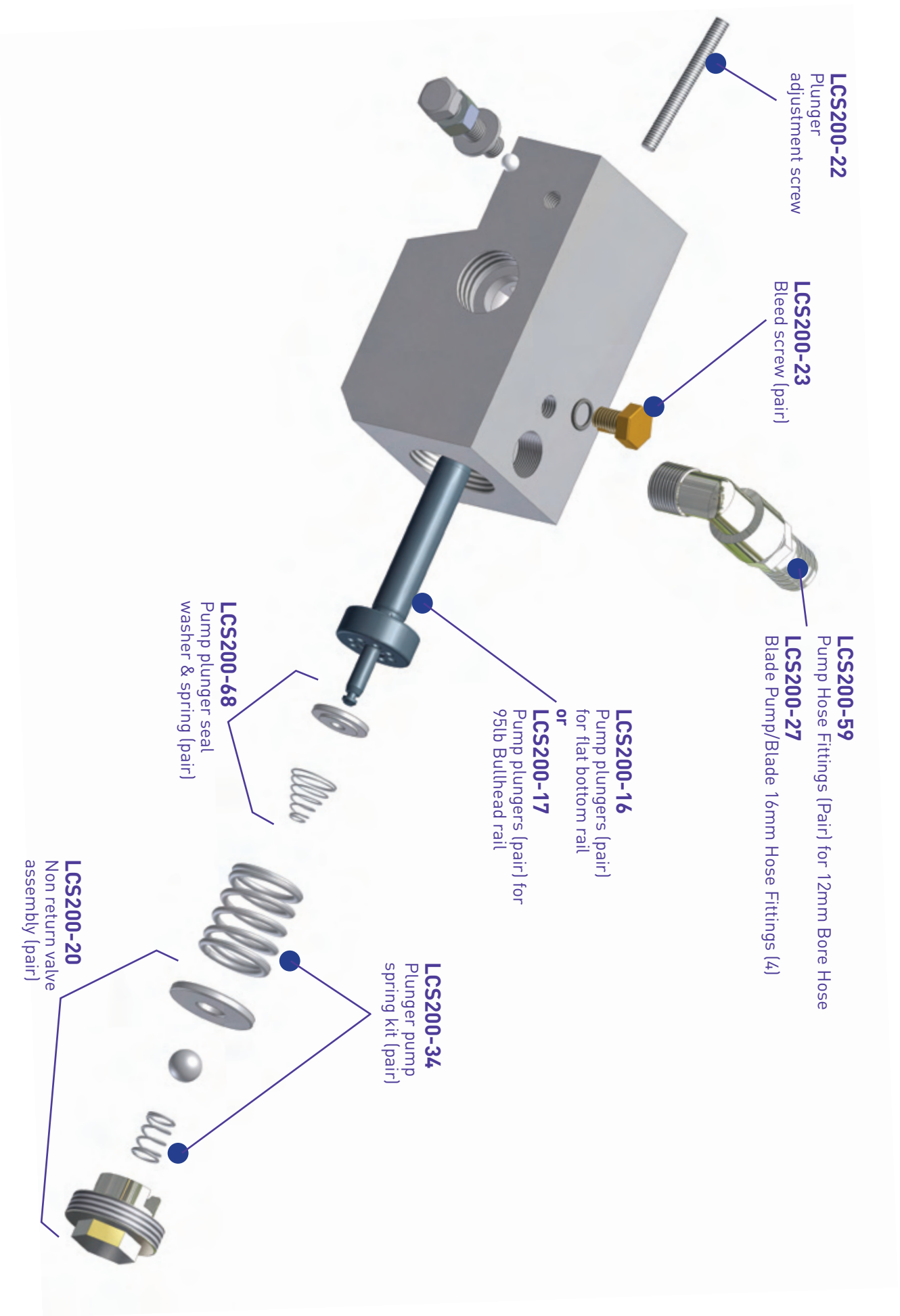

# Schematic of Pump for QHi Lubricurve PD50 mechanical rail lubricator on flat bottom rail

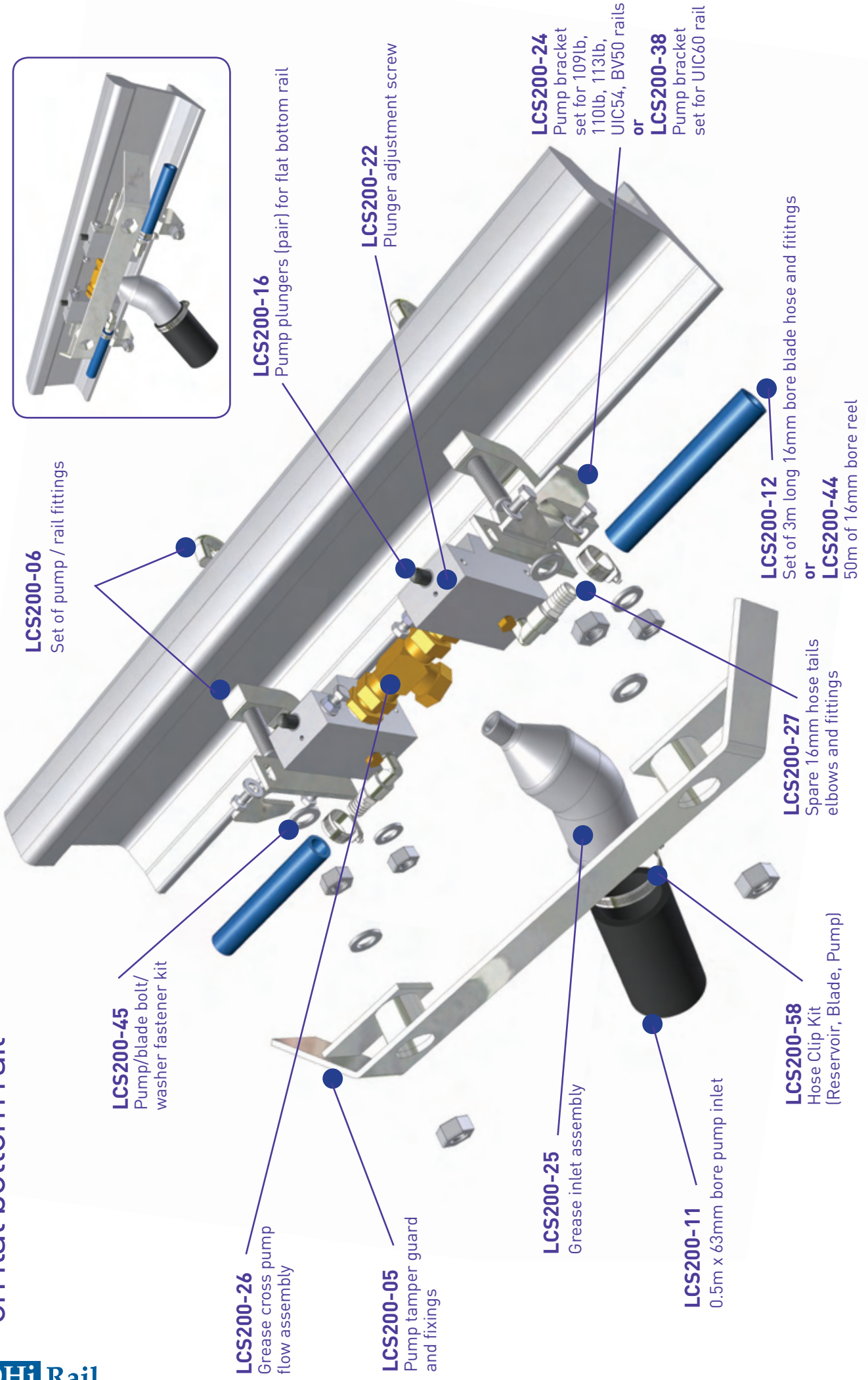

# Schematic of Easi-blade for flat bottom rail

LCS200-90

Pair of blades for 16mm bore hose

or

LCS200-96

Pair of blades for 12mm bore hose

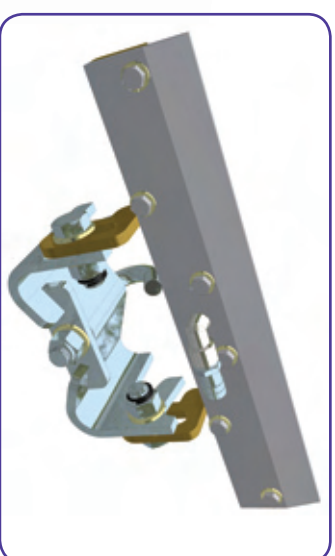

**LCS200-164**  
Rail clamp  
c/w hook and  
blade fixings

**LCS200-45**  
Blade bolt/  
Washer  
fastener kit

**LCS200-80**  
Pair of aluminium front  
plates and membranes  
15mm Ports

**LCS200-124**  
Pair of steel front  
plates and membranes  
15mm Ports

**LCS200-152**  
Pair of aluminium front  
plates and membranes  
10mm Ports

**LCS200-151**  
Pair of steel front  
plates and membranes  
10mm Ports

**LCS200-133**  
Hook Bolt

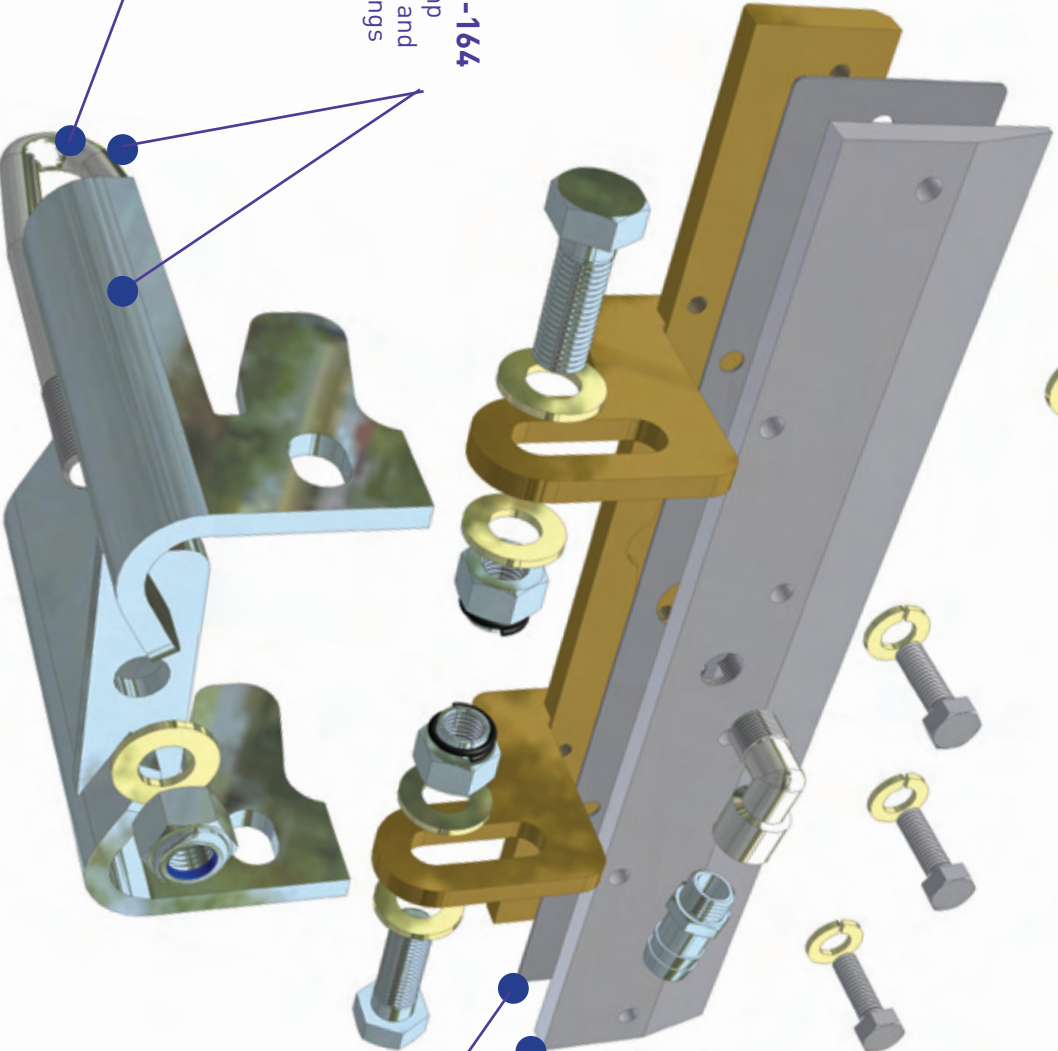

# Schematic of QHi Lubricurve PD50 mechanical reservoir

LCS102-01

**LCS102-04**  
Reservoir spider/  
piston retainer

**LCS200-73**  
Reservoir top hat spring plate

**LCS200-33**  
Reservoir fastener kit

**LCS200-71**  
Reservoir single spring set

**LCS200-32**  
Reservoir seal kit

**LCS102-10**  
Reservoir snap lock  
fittings & cap

**LCS200-74**  
Reservoir filler plate

**LCS102-26**  
High Flow Non  
Return Valve

**LCS200-58**  
Hose Clip

**LCS200-11**  
0.5m x 63mm Bore pump  
inlet hose & fittings

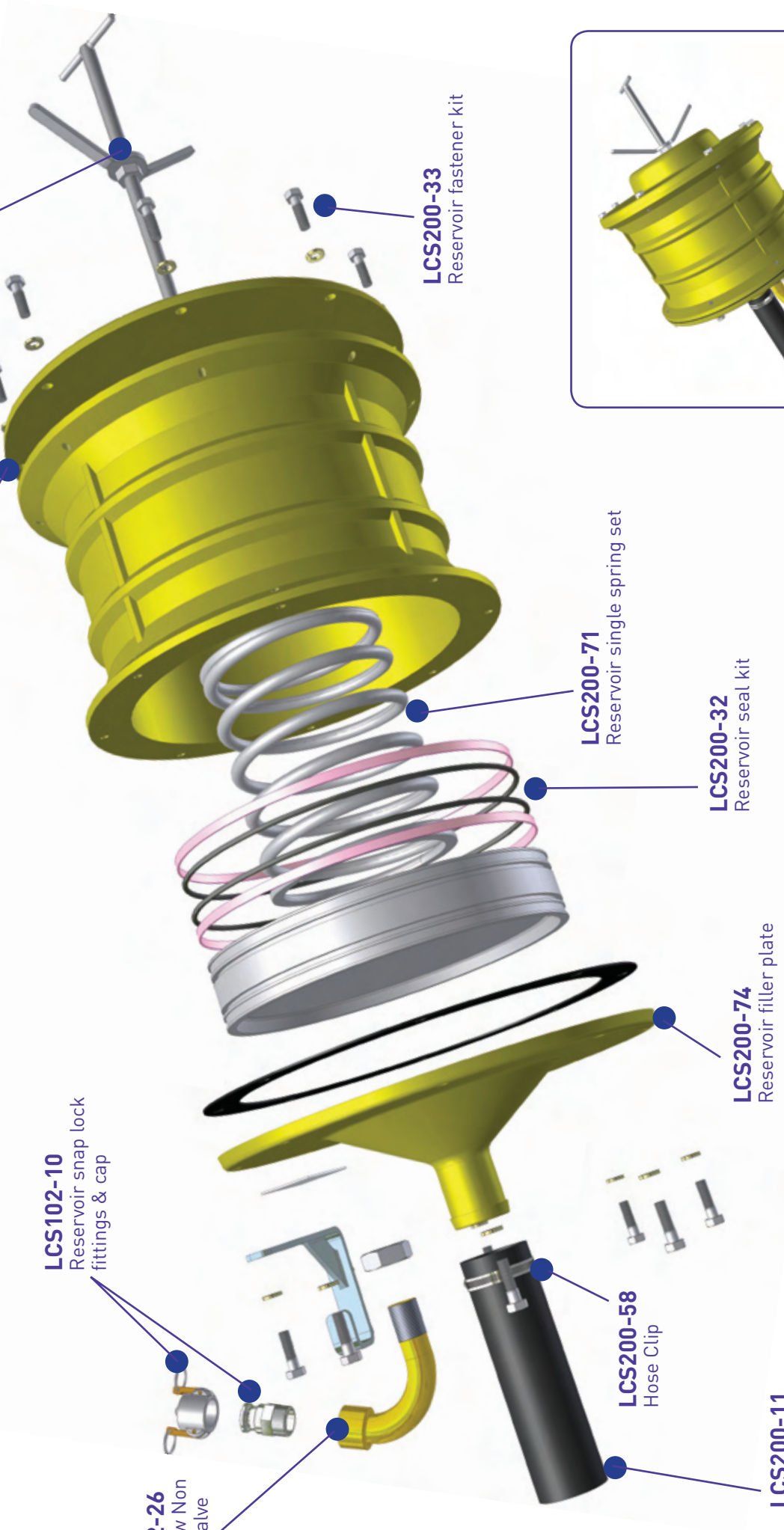
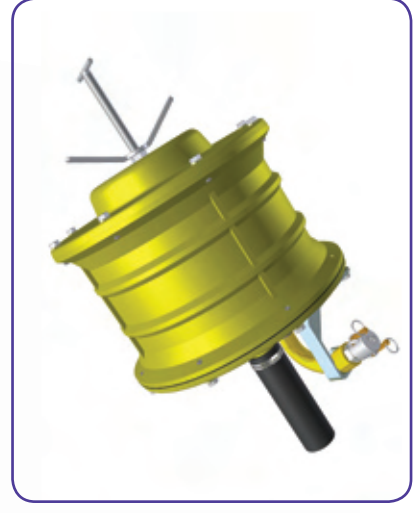

# LUBRICURVE EasiPump

## QHI PIVOTING SINGLE PUMP MECHANICAL RAIL LUBRICATOR

The Easipump has been designed as an alternative to the standard QHi double pump unit. Based on the same positive displacement technology it gives a lower cost option for running rail and check rail lubrication.

A single clamp ensures very quick installation and the pivoting clamp system means both the pump and the blades can now be lowered away from the rail face when rail grinding.

An Easipump rail lubricator can be used for conventional high rail lubrication but in addition can act as a true alternative to switch blade canister systems. The latter pump fixed volumes of grease irrespective of trains passing, whereas the Easipump delivers grease when and where it is required dependent on train activation.

**LOW COST**

**SINGLE QHI POSITIVE  
DISPLACEMENT PUMP**

**AVAILABLE WITH ONE  
OR TWO EASIBLADES**

**IDEAL FOR LIGHT AND  
HEAVY RAILWAYS**

**9KG OR 37KG  
RESERVOIR**

**POINT TIP  
LUBRICATION**

**FITS ALL RAIL  
PROFILES**

**QUICK TO INSTALL**

**IDEAL FOR CHECK  
RAIL AND RUNNING  
RAIL APPLICATIONS**



T: 0044 (0) 1582 461123

www.qhigroup.com

e-mail: sales@qhigroup.com

# LUBRICURVE EasiBlade

## QHi RUNNING RAIL GREASE DISTRIBUTION UNITS

The QHi EasiBlade is specially designed for quick, easy installation and maintenance for all types of running rail worldwide.

Eight large ports and wide grease channels reduce grease blockages and simple removal of six bolts exposes the inside of the blade for fast cleaning.

The unique pivoting mechanism allows lowering of the blade for rail grinding without removal of any parts so reducing time and component losses.

The EasiBlade can be used with any make of electric, mechanical, hydraulic or canister rail lubricators.

**SINGLE POINT  
ATTACHMENT**

**SPEEDY INSTALLATION**

**SIMPLE, QUICK AND EASY  
MAINTENANCE**

**HIGH QUALITY ANTI-  
VIBRATION NUTS**

**DROP AWAY FROM RAIL  
PRIOR TO GRINDING, LIFT  
AFTER GRINDING**

**NO LOOSE PARTS**

**SUITS UIC54 & UIC60 RAIL**

**OPTION FOR OTHER RAIL  
TYPES**

**12MM (1/2") OR 16MM  
(5/8") HOSE OPTIONS**

**NO GASKETS**



Blade in upright position



Blade dropped away for grinding



# LUBRICURVE EasiCheck

## QHi CHECK RAIL GREASE DISTRIBUTION UNITS

The QHi Easichack Blade is quick and easy to install on all types of check rail profiles.

Four large ports and wide grease channels reduce grease blockages, and unique simple removal of the top plate allows access to the inside of the blade for cleaning.

QHi check rail blades can be used on any make of electric, mechanical, hydraulic or canister rail lubricators.

**REMOVABLE TOP  
SECTION FOR ACCESS TO  
GREASE GROOVES**

**SPEEDY INSTALLATION**

**SIMPLE, QUICK AND EASY  
MAINTENANCE**

**MINIMISE PORT  
BLOCKING, MINIMISE  
MAINTENANCE**

**SUITS UIC69, UIC33,  
113A RAIL**

**OPTIONS FOR OTHER  
RAIL TYPES**

**12MM (1/2") OR 16MM  
(5/8") HOSE OPTIONS**

**SUITABLE FOR QHI AND  
OTHER  
MANUFACTURER'S  
LUBRICATORS**



EasiCheck system on UIC33 check with Flat bottom running rail



Easichack on UIC33 / U69 Rail

T: 0044 (0) 1582 461123

www.qhigroup.com

e-mail: sales@qhigroup.com

# LUBRICURVE Friction-Ease

## QHI FRICTION MODIFIER

High rail and check rail lubrication have now become good practice around the world to help promote long life of track and wheels. But as we increase our understanding of the antagonistic relationship between rail and wheel so we see other factors coming into play.

It is now evident that material is needed on the head of the rail to help prevent squeal, corrugation, low rail RCF and excessive fuel consumption in some railways.

QHi use both mechanical and electric rail lubricators to apply special friction modifiers to the head of the rail to help overcome the problems mentioned above.

Using modified blades on the field side of the rail, friction modifier can be applied in the right place and carried along the head of the rail by the wheel providing protection as required.

**APPLIED FROM  
MECHANICAL OR  
ELECTRIC RAIL  
LUBRICATORS**

**CARRY MORE THAN  
500 METRES FROM  
ONE UNIT**

**REDUCES SQUEAL**

**REDUCES  
CORRUGATION**

**REDUCES LOW RAIL  
RCF TO GIVE LARGE  
COST SAVINGS**

**REDUCES FUEL  
CONSUMPTION**

**FRICTION MODIFIER  
STILL VISIBLE ON  
TRACK AFTER  
500 METRES BUT  
EFFECTIVENESS  
CARRIES ON  
SIGNIFICANTLY  
FURTHER**



# WHITMORE'S BIO-RAIL

## BIO-DEGRADABLE GREASE FOR ALL RAIL LUBRICATORS

Whitmore's BioRail is used extensively on major railways across 3 continents. The combination of 111 years of lubricant manufacturing experience and a vast global distribution network ensures customers receive a consistent, high performance lubricant when and where you need it. In this environmentally conscious world, bio-degradability of any grease is imperative. Whitmore BioRail combines this necessary ecological requirement with excellent performance, this means the product can be used in all areas of a rail network, from mainline to depots to metros.



**BIO-DEGRADABLE**

**DECREASES RAIL WEAR**

**REDUCES WHEEL  
SQUEAL**

**PROTECTS THE  
ENVIRONMENT**

**STAYS ON THE RAIL EVEN  
DURING HEAVY RAIN**

**REDUCED BLADE PORT  
BLOCKAGES**

**WIDE TEMPERATURE  
TOLERANCE**

**CONSISTENT PRODUCT  
PERFORMANCE**



T: 0044 (0) 1582 461123

www.qhigroup.com

e-mail: sales@qhigroup.com

# NULUBE POINTS LUBRICANT

HIGH QUALITY PTFE SPRAY AND PASTE FOR  
SLIDE CHAIRS AND CLAMP-LOCKS.



QHi Nulube QH90 is a very high quality Teflon lubricant suitable for slide chairs (paste) and clamplock (spray) lubrication. The Teflon is cracked into small molecules to provide excellent lubrication for sheering forces as required for points protection.

Nulube has a proven record of extending periods between lubrication. This can be up to 3X longer than other products, ensuring less failures and therefore less fines from train operators.

**EXCELLENT  
PERFORMANCE  
BENEFITS**

**LOW VOLUME REQUIRED**

**MONOLAYER PROVIDES  
ADEQUATE LUBRICATION**

**SUITABLE FOR ANY  
MATERIAL**

**REDUCES METAL  
CORROSION**

**AVOIDS WASH OFF BY  
RAIN**

**EXTENDED PERIODS  
BETWEEN LUBRICATION**

**-40C TO 300C WORKING  
RANGE**

**SPRAY OR PASTE**



# INDEX

Bio-degradable grease.....	18
Blades .....	2,3,7,8,9,11,14,15,16
Canister rail lubricators.....	7,8
Contents.....	1
Easiblade .....	2,3,8,9,11,14,15
Easichack.....	16
Electric rail lubricator .....	2,3,4,5,6
Electro 10/20 lubricator .....	2,3,4,5,6
Flatbottom rail blades.....	11
Flatbottom rail pump .....	10
Friction Modifiers .....	17
Grease distribution units.....	2,3,8,9,11,14,15,16
Grease – biodegradable .....	18
Grease – points lubrication.....	19
Lubricurve Easiblade .....	2,3,8,9,11,14,15
Lubricurve Easichack.....	16
Lubricurve Easipump .....	14
Lubricurve Electro 10/20 Electric rail lubricator .....	2,3,4,5,6
Lubricurve Friction-Ease .....	17
Lubricurve PD50 Mechanical rail lubricator .....	9,10,11,12,13
Mechanical pump .....	10,14
Mechanical rail lubricator.....	9,10,11,12,13,14
Memolub (canister rail lubricator).....	7,8
Memolub grease refill cartridges .....	7,8
Nulube points grease .....	19
Points grease.....	19
Reservoir.....	9,13
Schematics	
-Electro 10/20/30 .....	4,5,6
-Lubricurve PD50 .....	9,10,11,12,13
-Memolub .....	8
Solar panels.....	2,3,4,5
Whitmore Bio-rail biodegradable grease.....	18
Wind turbines .....	2,4

Distributed by

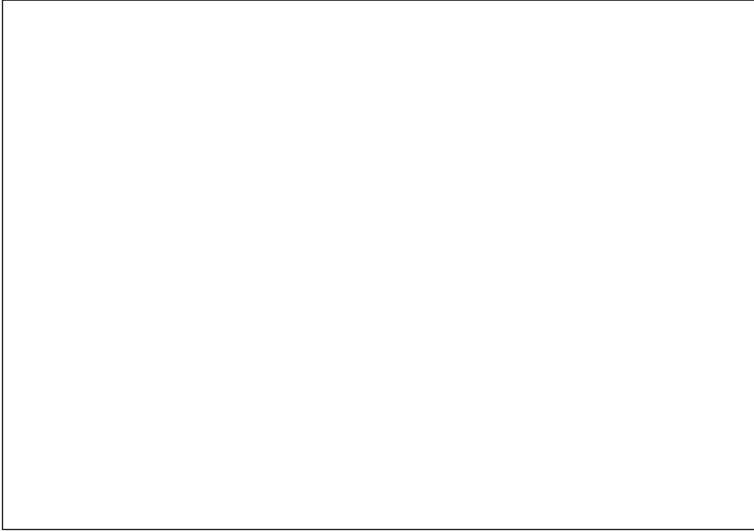

QHi Rail Ltd  
Talisman House  
Allied Business Centre  
Coldharbour Lane  
Harpenden  
Herts AL5 4UT

T: 0044 (0) 1582 461123  
[www.qhigroup.com](http://www.qhigroup.com)  
e-mail: [sales@qhigroup.com](mailto:sales@qhigroup.com)